

TH6050HD - outdoor cladding

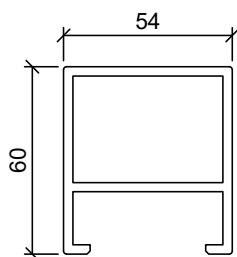

MOUNTING SYSTEM

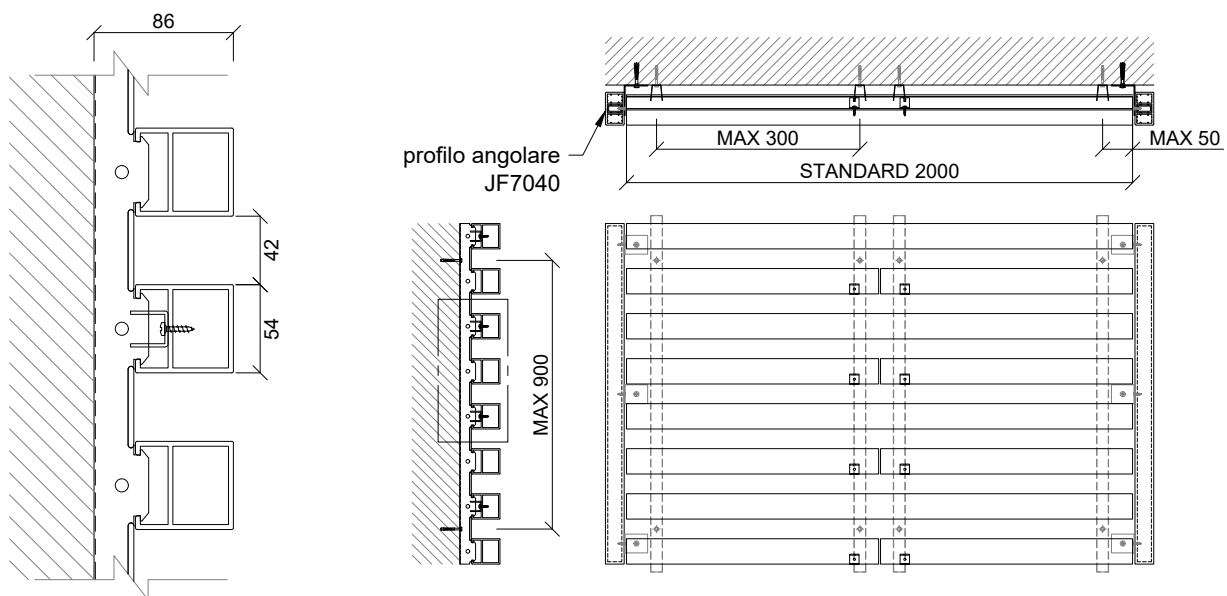

WEIGHT OF THE SYSTEM ≈ 14.30 kg/sqm

- Measures in millimeters
- Dimensions considering a standard wind load of 120 kg/m²

ASSEMBLY INSTRUCTIONS



1. Screw the ZSSW-LG9637V profiles to support with suitable screws and wall plugs (*).

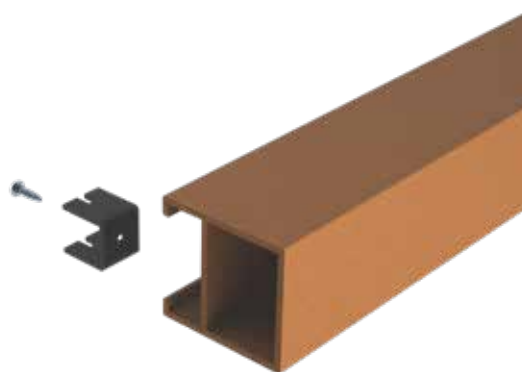

2. Apply the clip for the FIXED POINT with self-drilling screws to the profile.



3. Install the first TH6050HD profile.

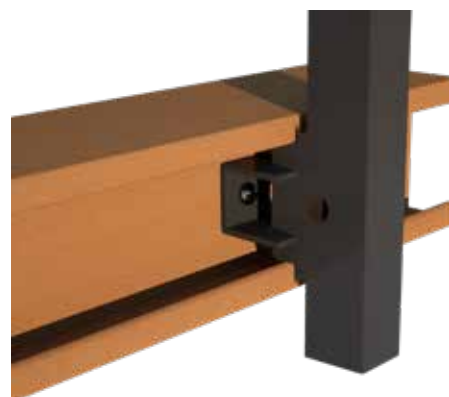

4. NOTE: the clip has to slot in the substructure.



5. Install, if expected, the accessory THZ5004HD profile.



6. Repeat as described from step 2 up to the top to complete the cladding.

*Screws and wall plugs must be chosen according to the type of wall support.

DETAILS FOR CORNERS



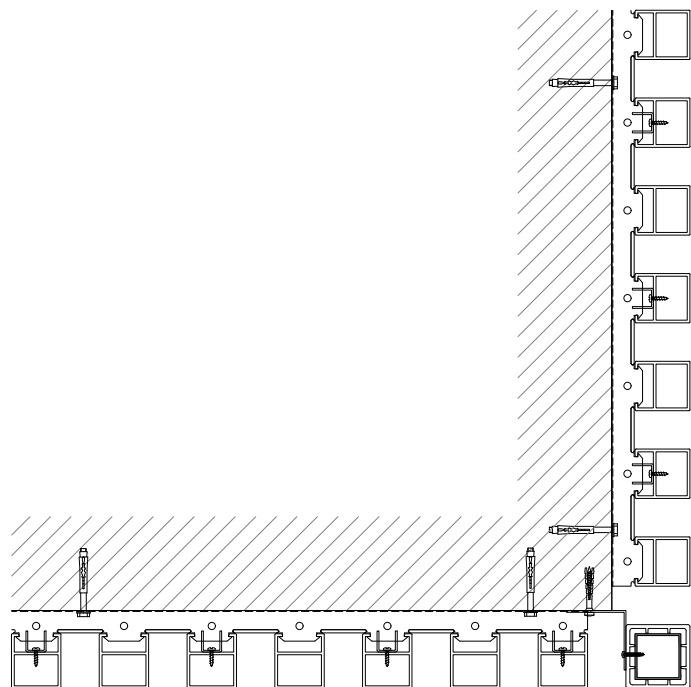

VERTICAL PLANKS

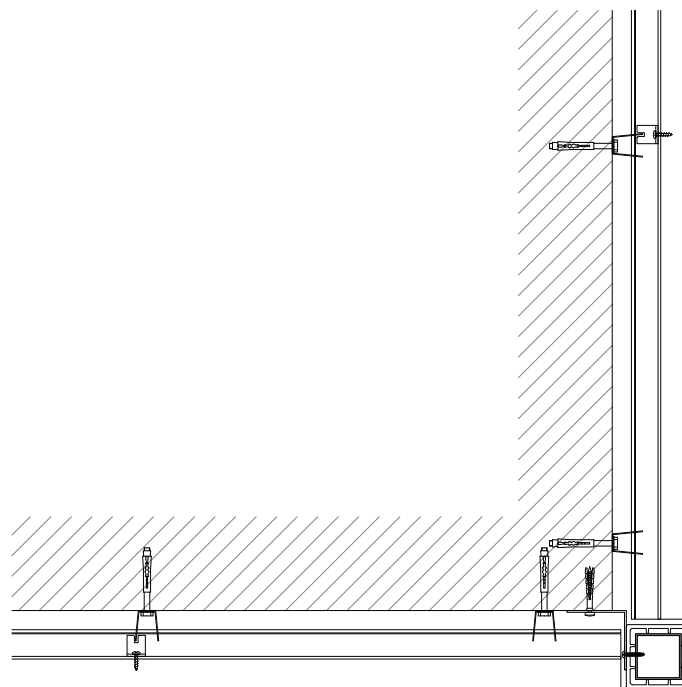

HORIZONTAL PLANKS



SYSTEM COMPONENTS

Profile TH6050HD		10.50 m/sqm	Substructure profile ZSSW-LG9637V		5.00 m/sqm (stacked bond) 5.70 m/sqm (running bond)
Clip for fixed point ZCLW-KK2722		6 pz/sqm	Screw ZRHW-3.5X16- A2-7504N		6 pz/sqm
Accessory closing piece THZ5004HD		10.50 m/sqm			

CORNERS COMPONENTS

Profile JF7040-30x15		Profile JF7070		Fixing bracket ZCLW- WAQ20410_6040		Screw ZRHW-3.5X19- A2-7504N	
-------------------------	---	-------------------	---	--	---	-----------------------------------	---

WARNING: the incidences of accessory material indicated refer to application according to the European standards, which provides for planks 2000 mm long and slats/substructure with maximum distance o.c up to 300 mm. For any installation that differs from the standard a cutting plan must be designed; it shall calculate precisely the number of points of intersection between the planks and the substructure, allowing the correct identification of the number of clips and screws required for each type of application.