

TH14830HD-4 - outdoor cladding

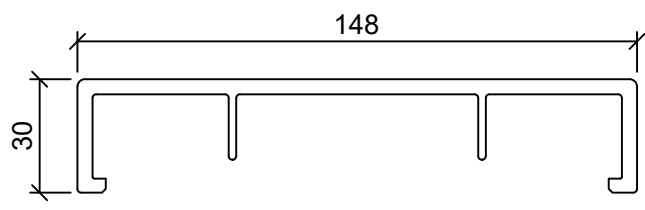

MOUNTING SYSTEM

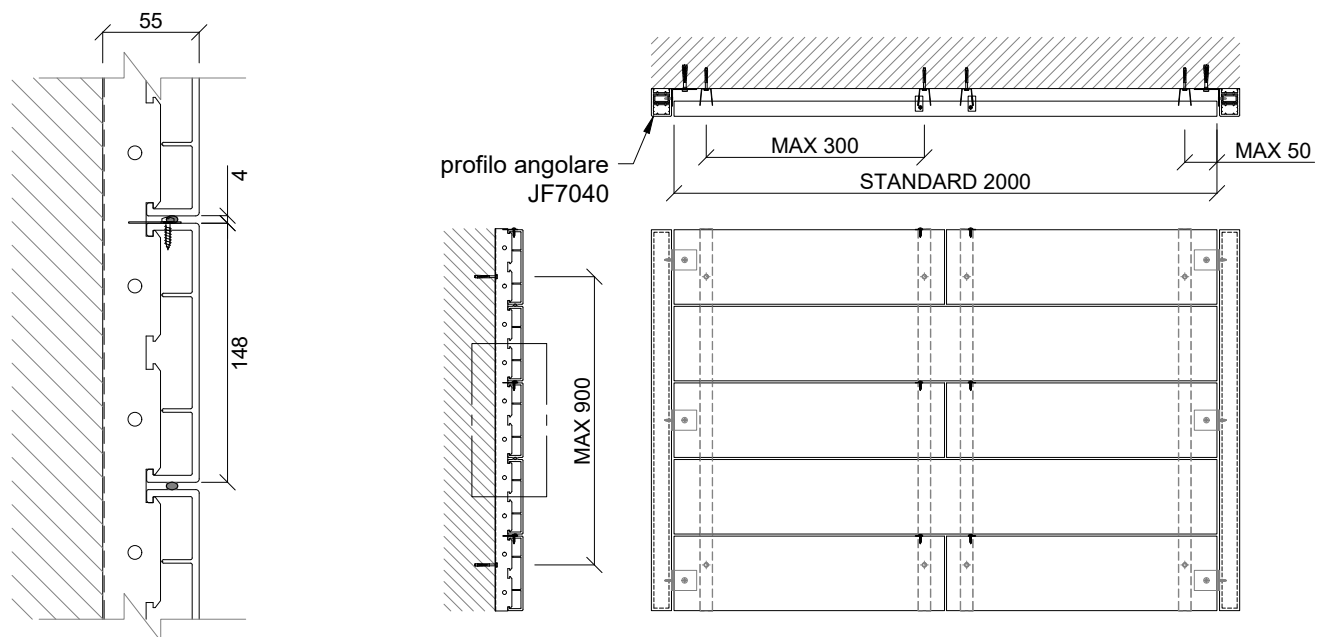

- WEIGHT OF THE SYSTEM ≈ 9.60 kg/sqm
- Measures in millimeters
 - Dimensions considering a standard wind load of 120 kg/m²

ASSEMBLY INSTRUCTIONS



1. Screw the ZSSW-LG3326V profiles to support with suitable screws and wall plugs (*).



2. Install the first TH14830HD-4 profile.



3. Apply the clip for the FIXED POINT with self-drilling screws to the profile.



4. NOTE: the clip has to slot in the substructure.



5. Repeat as described from step 2 up to the top to complete the cladding.

*Screws and wall plugs must be chosen according to the type of wall support.

DETAILS FOR CORNERS

VERTICAL PLANKS

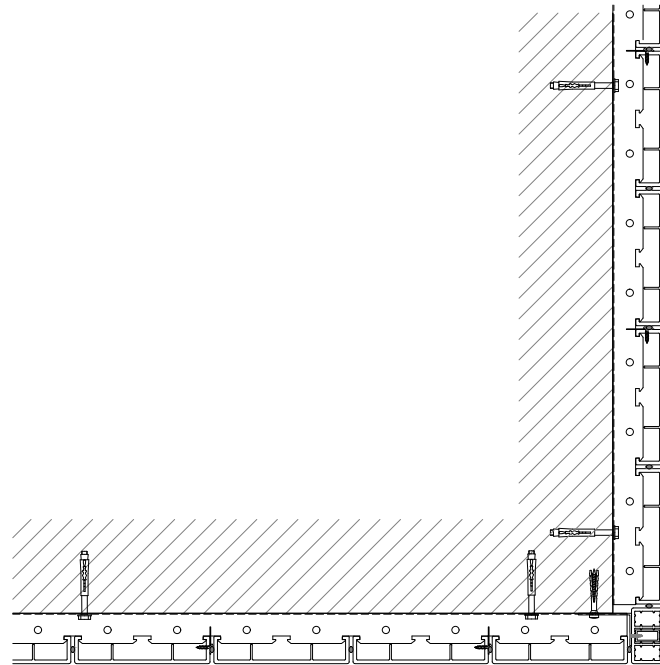

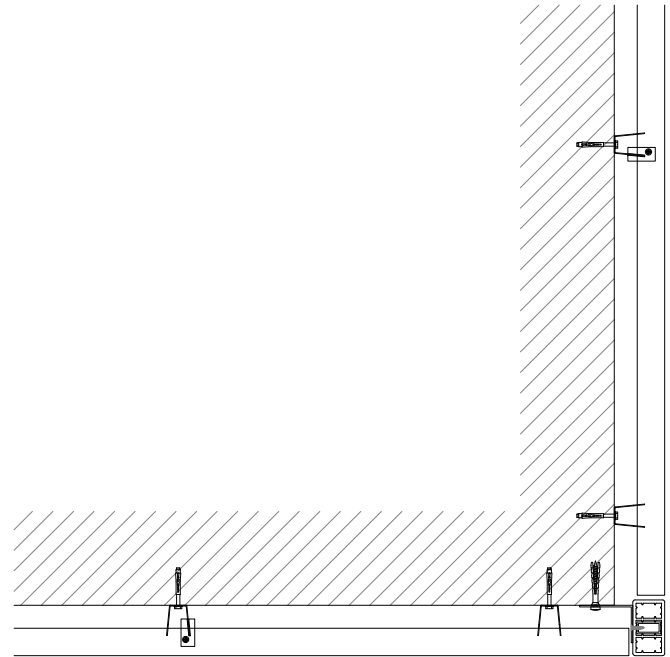

HORIZONTAL PLANKS





SYSTEM COMPONENTS

Profile TH14830HD-4		6.60 m/sqm
Clip for fixed point ZCLW-KK3015		4 pz/sqm

Substructure profile ZSSW-LG3326V joint 4 mm		5.00 m/sqm (stacked bond) 5.70 m/sqm (running bond)
Screw ZRHW-3.5X16- A2-7504N		4 pz/sqm

CORNERS COMPONENTS

Profile JF7040-30x15	
-------------------------	-------------------------------------------------------------------------------------

Fixing bracket ZCLW- WAQ20410_6040	
------------------------------------------	--------------------------------------------------------------------------------------

Screw ZRHW-3.5X19- A2-7504N	
-----------------------------------	---------------------------------------------------------------------------------------

WARNING: the incidences of accessory material indicated refer to application according to the European standards, which provides for planks 2000 mm long and slats/substructure with maximum distance o.c. up to 300 mm. For any installation that differs from the standard a cutting plan must be designed; it shall calculate precisely the number of points of intersection between the planks and the substructure, allowing the correct identification of the number of clips and screws required for each type of application.