

Q20410 - outdoor cladding

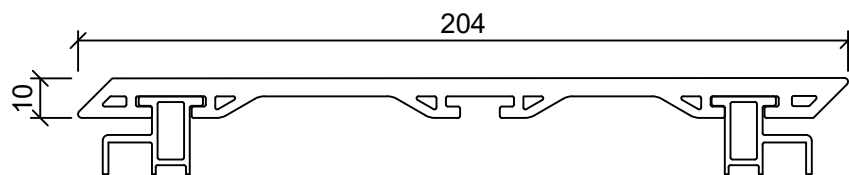

MOUNTING SYSTEM

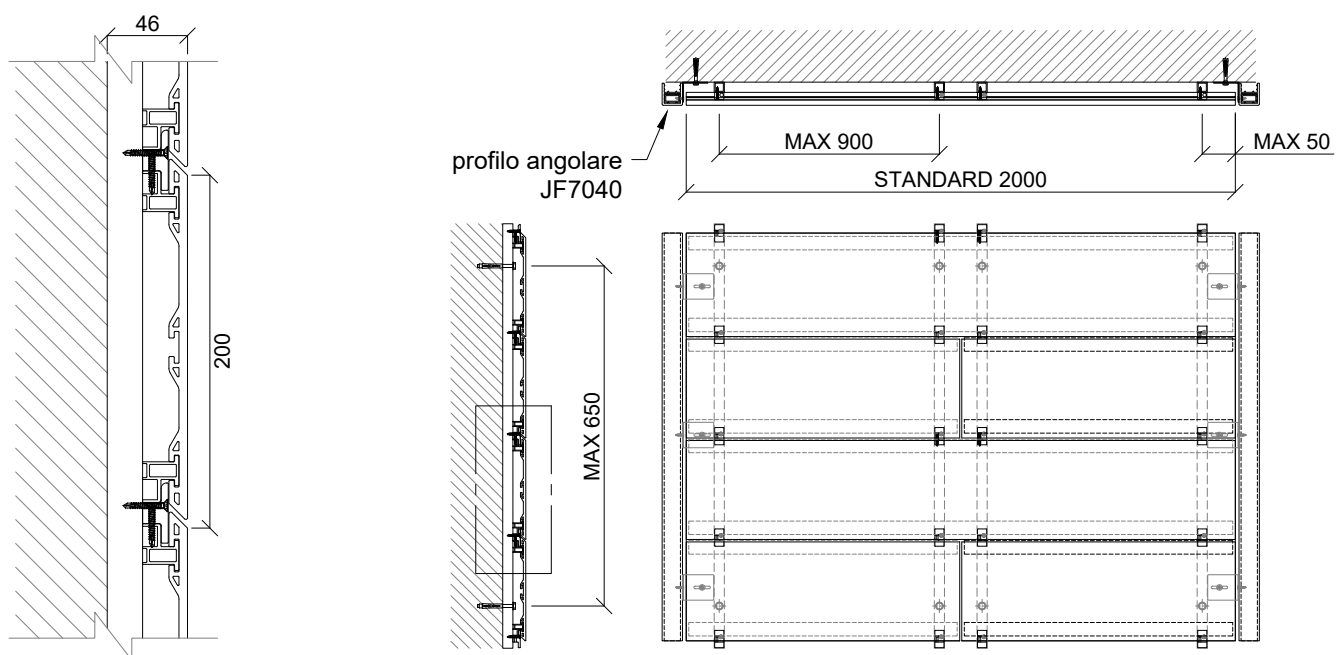

WEIGHT OF THE SYSTEM ≈ 12.40 kg/sqm

- Measures in millimeters
- Dimensions considering a standard wind load of 120 kg/m²

ASSEMBLY INSTRUCTIONS



1. Screw the aluminum joist profiles to support with suitable screws and wall plugs (*).



2. Apply the first row of ZCLW-KK3418 clips at the bottom with self-drilling screws.

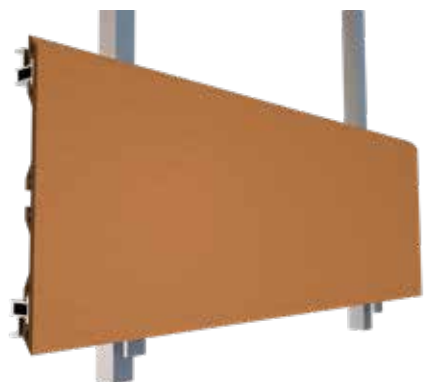

3. Insert the first plank into the respective clip slot matching the aluminium reinforcements at the back.



4. Insert the second row of clips to lock the plank.

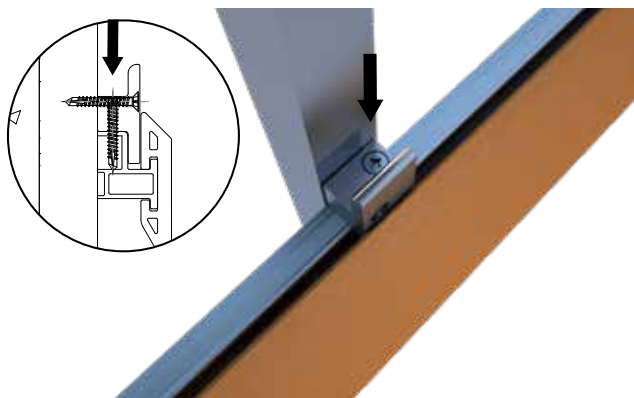

5. Install the screw to form the fixed point (make a pilot hole to make the step easier). Only apply 1 fixed point for each plank.



6. Repeat as described from step 3 up to the top to complete the cladding.

*Screws and wall plugs must be chosen according to the type of wall support.

ALTRNATIVE - STARTING WITH "Z" PROFILE



1. Screw the aluminum joist profiles to support with suitable screws and wall plugs (*).



2. Install the Z starting profile in the lower part using self drilling screws. Continue with points 3 to 6 of the previous page.

CUTTING THE PROFILES



1. Remove the screws from the fixed points.

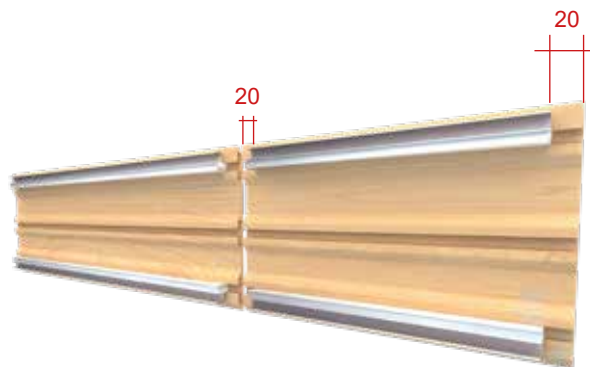

2. Cut the profiles to the required length. The aluminum profiles must be cut 40 mm shorter than the Woodn profile.



3. Insert the screws into the fixed points (ZRHW-3.5X13-A2-7504N).

NOTE: on each profile Q20410-WA 2 fixed point screws must be applied.

DETAILS FOR CORNERS



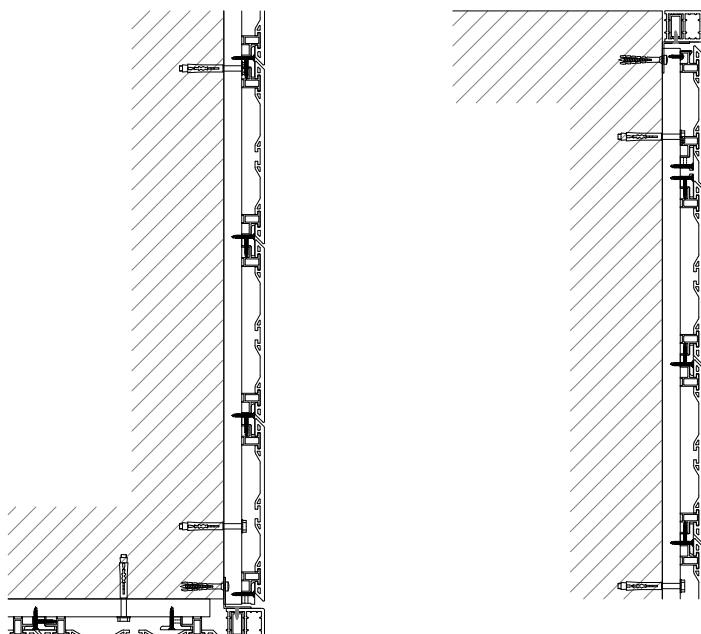

VERTICAL PLANKS

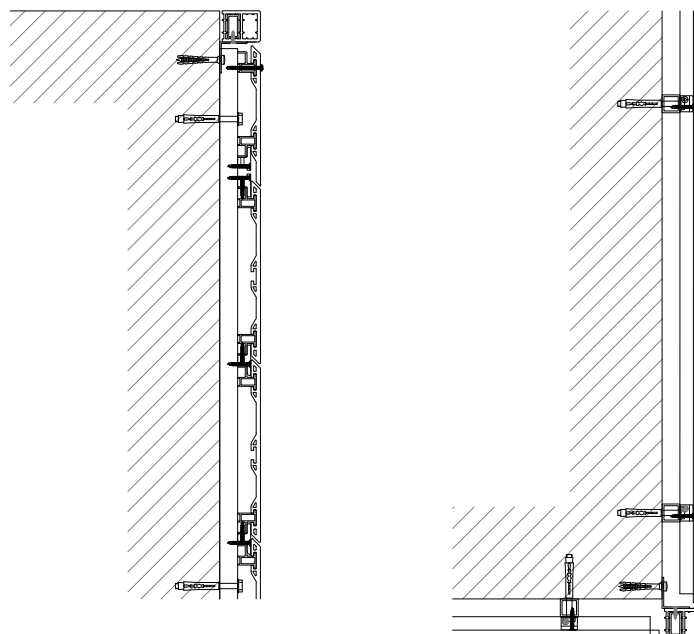

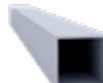

HORIZONTAL PLANKS



SYSTEM COMPONENTS

Profile Q20410		5.0 m/sqm	Substructure profile ZTQM-20X20X2-6060-T6		1.70 m/sqm (stacked bond) 2.20 m/sqm (running bond)
Fixing clip ZCLW-KK3418 (Alloy ZAMAK 3)		9 pz/sqm (stacked bond) 11 pz/sqm (running bond)	Screw ZFHC-3.5X25-A2-7504P		12 pz/sqm (stacked bond) 14 pz/sqm (running bond)
Fixing clip ZCLW-KK1515		available upon request	Z starting profile ZTQW-10X10X13X1.5-6060-T6		available upon request

CORNERS COMPONENTS

Profile JF7040-30x15		Fixing bracket ZCLW-WAQ20410_6040		Screw ZRHW-3.5X19-A2-7504N	
-------------------------	---	--------------------------------------	--	-------------------------------	---

WARNING: the incidences of accessory material indicated refer to application according to the European standards, which provides for planks 2000 mm long and slats/substructure with maximum distance o.c. up to 900 mm. For any installation that differs from the standard a cutting plan must be designed; it shall calculate precisely the number of points of intersection between the planks and the substructure, allowing the correct identification of the number of clips and screws required for each type of application.